

vtech[®]
Baby

User's Manual

Pop-Up Friends Train



© 2014 VTech
Printed in China
91-009680-001 UK

VTech understands that a child's needs and abilities change as they grow and with that in mind we develop our toys to teach and entertain at just the right level...

vtech Baby

Toys that will stimulate their interest in different textures, sounds and colours

I am...

...responding to colours, sounds and textures

...understanding cause and effect

...learning to touch, reach, grasp, sit-up, crawl and toddle

Birth-36 months



Pre-School

Interactive toys to develop their imagination and encourage language development

I want...

...to get ready for school by starting to learn the alphabet and counting

...my learning to be as fun, easy and exciting as can be

...to show my creativity with drawing and music so my whole brain develops

3-6 years



Electronic Learning Computers

Cool, aspirational and inspiring computers for curriculum related learning

I need...

...challenging activities that can keep pace with my growing mind

...intelligent technology that adapts to my level of learning

...National Curriculum based content to support what I'm learning at school

4-10 years



To learn more about this and other VTech® products, visit www.vtechuk.com

INTRODUCTION

Thank you for purchasing the **VTech® Pop-Up Friends Train** learning toy!

All aboard! Meet the happy animals on the **VTech® Pop-Up Friends Train** and join them on a fun journey learning about animals, animal sounds and colours. Press the button, flip the switch and turn the gear for fun animal surprises. The train is ready to go, all aboard!

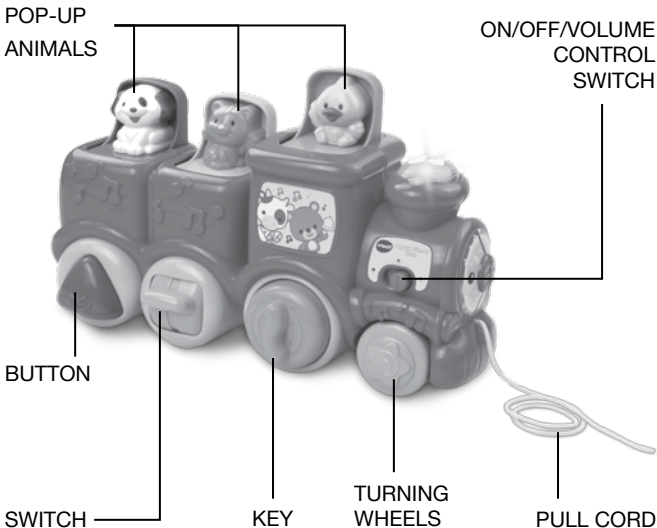

INCLUDED IN THIS PACKAGE

- One VTech® Pop-Up Friends Train learning toy
- One user's manual

WARNING: All packing materials, such as tape, plastic sheets, wire ties and tags are not part of this toy, and should be discarded for your child's safety.

NOTE: Please keep this instruction manual as it contains important information.

WARNING: The cord is not part of this toy. For your child's safety, please cut and discard the cord before assembling the product.



BATTERY INSTALLATION

1. Make sure the unit is turned OFF.
2. Locate the battery cover on the back of the unit. Use a screwdriver to loosen the screw.
3. Install 2 new AAA (AM-4/LR03) batteries following the diagram inside the battery box. (The use of new alkaline batteries is recommended for maximum performance.)
4. Replace the battery cover and tighten the screw to secure.

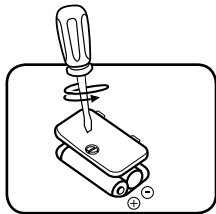

BATTERY NOTICE

- Use new alkaline batteries for maximum performance.
- Use only batteries of the same or equivalent type as recommended.
- Do not mix different types of batteries: alkaline, standard (carbon-zinc) or rechargeable (Ni-Cd, Ni-MH), or new and used batteries.
- Do not use damaged batteries.
- Insert batteries with the correct polarity.
- Do not short-circuit the battery terminals.
- Remove exhausted batteries from the toy.
- Remove batteries during long periods of non-use.
- Do not dispose of batteries in fire.
- Do not charge non-rechargeable batteries.
- Remove rechargeable batteries from the toy before charging (if removable).
- Rechargeable batteries are only to be charged under adult supervision.

Disposal of batteries and product



The crossed-out wheellie bin symbols on products and batteries, or on their respective packaging, indicates they must not be disposed of in domestic waste as they contain substances that can be damaging to the environment and human health.

The chemical symbols Hg, Cd or Pb, where marked, indicate that the battery contains more than the specified value of mercury (Hg), cadmium (Cd) or lead (Pb) set out in Battery Directive (2006/66/EC).



The solid bar indicates that the product was placed on the market after 13th August, 2005.

Help protect the environment by disposing of your product or batteries responsibly.

For more information, please visit:

www.recycle-more.co.uk

www.recyclenow.com

PRODUCT FEATURES

1. ON/OFF/VOLUME CONTROL SWITCH

To turn the unit **ON**, slide the **ON/OFF/VOLUME CONTROL SWITCH** to the **LOW VOLUME** (🔊) or **HIGH VOLUME** (🔊) position. To turn the unit **OFF**, slide the **ON/OFF/VOLUME CONTROL SWITCH** to the **OFF** (●) position.



2. PULL CORD

To convert the unit from a push toy to a pull toy, remove the pull cord from the storage compartment on the bottom of the train. For your child's safety we suggest you store the pull cord in the compartment until your child is walking.

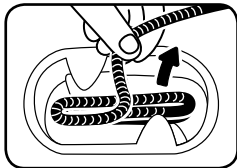

3. AUTOMATIC SHUT-OFF

To preserve battery life, the **VTech® Pop-Up Friends Train** will automatically power-down after approximately 30 seconds without input. The unit can be turned on again by pressing any button.

ACTIVITIES

1. Slide the **on/off/volume control switch** to turn the unit on. You will hear train sounds, a phrase and a song. The light will flash with the sounds.
2. Press the **button** to pop up the dog. You will hear the animal name and colour identified as well as a fun song, sounds and tunes. Press the button when the animal is already popped up to hear a playful tune. The light will flash with the sounds.
3. Flip the **switch** to pop up the cat. You will hear the animal name and colour identified as well as a fun song, sounds and tunes. Press the button when the animal is already popped up to hear a playful tune. The light will flash with the sounds.
4. Turn the **key** to pop up the bird. You will hear the animal name and colour identified as well as a fun song, sounds and tunes. Press the button when the animal is already popped up to hear a playful tune. The light will flash with the sounds.

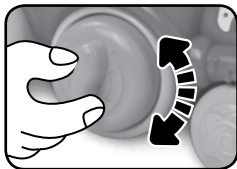
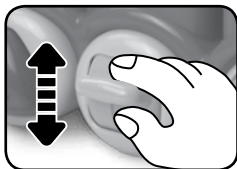
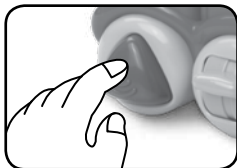

5. Press the animals down into the train to hear a playful phrase. The light will flash with the sounds.
6. Pull or push the train to hear fun train sounds and random melodies. The light will flash with the sounds.



MELODY LIST

1. London Bridge
2. Yankee Doodle
3. Where Has My Little Dog Gone?
4. Pop! Goes the Weasel
5. Turkey in the Straw
6. Animal Fair
7. A-Tisket, A-Tasket
8. Here We Go Round the Mulberry Bush
9. Pussy Cat, Pussy Cat
10. Skip to My Lou
11. Three Blind Mice
12. Grandfather's Clock
13. Toyland
14. I've Been Working on the Railroad
15. Ring Around the Rosy
16. Aiken Drum

Sing-Along Song Lyrics

Sing-Along Song 1

Are you ready?

Here comes the train.

Chugga-chugga, choo-choo,

Chugga-chugga, choo-choo.

Off we go!

Sing-Along Song 2

I'm popping up to say,

We're going on a trip,

Don't forget to pack your things!

Sing-Along Song 3

I'm popping up to say,

Clickety-clack, I love riding down the track!

Sing-Along Song 4

I'm popping up to say,

I'm always ready for an adventure.

Where should we go?

CARE & MAINTENANCE

1. Keep the unit clean by wiping it with a slightly damp cloth.
2. Keep the unit out of direct sunlight and away from any direct heat source.
3. Remove the batteries when the unit will not be in use for an extended period of time.

4. Do not drop the unit on hard surfaces and do not expose the unit to moisture or water.
5. This toy works best indoors on smooth surfaces.

TROUBLESHOOTING

If for some reason the program/activity stops working or malfunctions, please follow these steps:

1. Please turn the unit OFF.
2. Interrupt the power supply by removing the batteries.
3. Let the unit stand for a few minutes, then replace the batteries.
4. Turn the unit ON. The unit should now be ready to play again.
5. If the product still does not work, replace with a new set of batteries.

If the problem persists, please call our Consumer Services Department on 01235 546810 (from UK) or +44 1235 546810 (outside UK) and a service representative will be happy to help you.

IMPORTANT NOTE:

Creating and developing **VTech**[®] products is accompanied by a responsibility that we take very seriously. We make every effort to ensure the accuracy of the information, which forms the value of our products. However, errors sometimes can occur. It is important for you to know that we stand behind our products and encourage you to call our Consumer Services Department on 01235 546810 (from UK) or +44 1235 546810 (outside UK), with any problems and/or suggestions that you might have. A service representative will be happy to help you.



CLASS 1
LED PRODUCT



PRODUCT WARRANTY



Thank you for choosing this quality product from VTech. We hope it will bring many hours of entertainment, imaginative play and learning.

1. The product detailed above is covered by a one year warranty from the date of purchase, against any defects in materials or workmanship.
2. The product may be returned to the place of purchase. Alternatively the product can be returned to VTech Electronics Europe plc (see address below), with proof of purchase, without proof of purchase no replacement will be provided.
3. VTech Electronics Europe plc will examine the product and if it is found to be defective due to faulty materials or workmanship, will replace the product at their discretion.
4. If the product covered by this warranty is damaged due to misuse, modification or unauthorised repair, or because of faulty batteries, battery discharge or incorrect electrical connections, then this warranty becomes void.
5. This warranty is personal to the original purchaser and is not transferable.
6. Breakages to the LCD screen are not covered by the warranty.
7. Returns to VTech Electronics Europe plc should include a cheque or postal order for £1.50 towards the cost of return postage and packaging.
8. Products returned to VTech Electronics Europe plc, should be addressed as follows and packed carefully to avoid damage in transit (Please do not include batteries or adaptor).
Please include details of the fault together with your name and address.

VTech Electronics Europe plc, c/o Tablogix Limited, 200 Milton Park, Abingdon, Oxon OX14 4TA

THIS WARRANTY IS OFFERED AS AN EXTRA BENEFIT AND DOES NOT AFFECT CONSUMERS' STATUTORY RIGHTS.

This warranty is valid for the UK and Eire only. For products purchased outside the UK and Eire, please contact your local distributor or place of purchase.

